

DS Creator Pro

for NS02A8/E8 & NS02V2



DS Creator Pro

Introduction

“DS Creator Pro” is an application for Shuttle XPC NS02A8/E8 and NS02V2 series. You can use “DS Creator Pro” on your Android devices or iOS devices to upload digital signage contents such as scrolling text, pictures, videos and webpage links to your digital signage player by following these simple steps.

“DS Creator Pro” app runs with Android 8.X and iOS 11.X or higher above provided by the manufacturer.

Preparing for first-time use

First of all, you need to install the “DS Creator Pro” app from [Google Play](#) or [Apple store](#)

Second, you need to connect your phone or tablet through in the same local area network (LAN) as the Shuttle XPC NS02A8/E8 and NS02V2 series:

1. On your client device, tap on Settings and select Wi-Fi.
2. Turn on Wi-Fi then choose a network name.
3. Confirm that your device is connected to the same LAN as the NS02A8/E8 or NS02V2 series.
4. Make sure the built-in “DS Creator Pro” app on the NS02A8/E8 or NS02V2 series is running (so that the project content can be uploaded from your client device).

Contents

<u>Overview on a client device</u>	3
<u>How does it work on a client device</u>	4
<u>Supported format</u>	6
<u>Type description</u>	7
<u>Scrolling Text</u>	8
<u>Picture and Video</u>	9
<u>Webpage</u>	10
<u>Play your project</u>	11
<u>Edit your project</u>	11
<u>Upload your project to NS02 series</u>	12
 <u>Overview on the NS02 series</u>	 13
<u>How does it work on a NS02 series</u>	15
<u>Supported format</u>	16
<u>Type description</u>	17
<u>Scrolling Text</u>	18
<u>Picture and Video</u>	19
<u>Webpage</u>	20
<u>Play your project</u>	21
<u>Edit your project</u>	21
<u>Set schedule on a NS02 series</u>	22

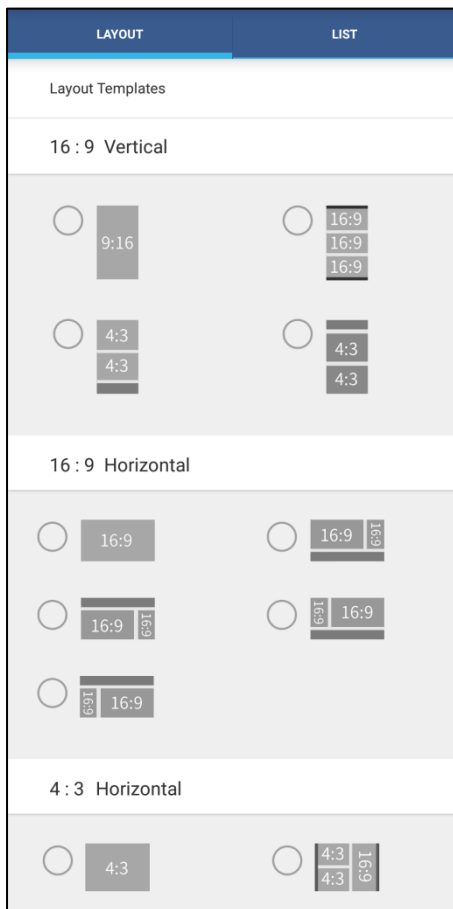

Overview on a client device

Start the “DS Creator Pro” app on your client device.
There are 11 types of layout templates for your needs.

Scrolling Text

- Default size: 48 pt
- Font size: 30-200 pt

Picture

- Format: JPG, PNG, GIF, BMP

Video

- Format: MPEG-4(H.264/8-bit), 3GPP (Android devices only)

Webpage (only supports single frame layout)

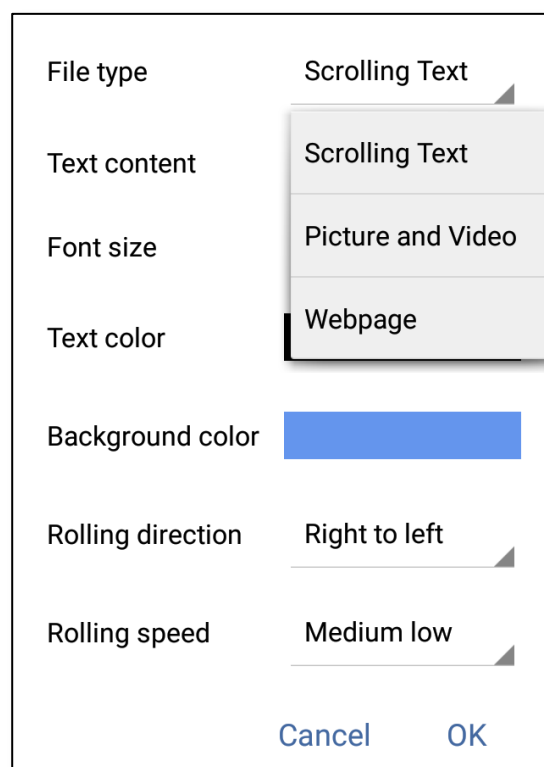
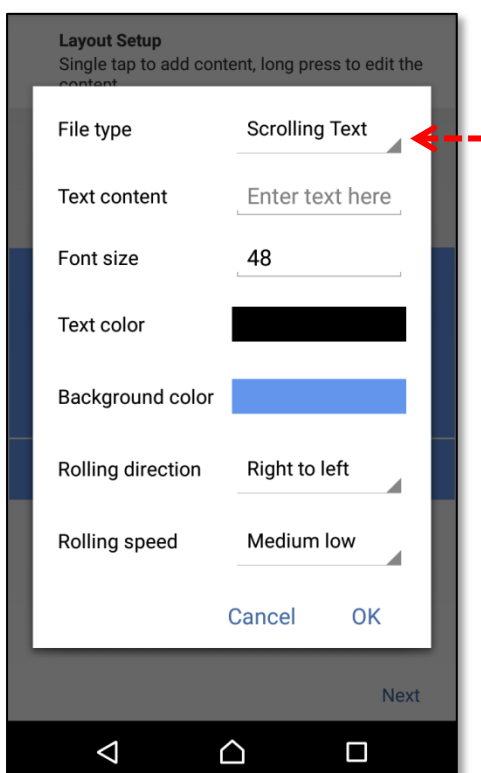

- Recommend: RWD (Responsive Web Design)

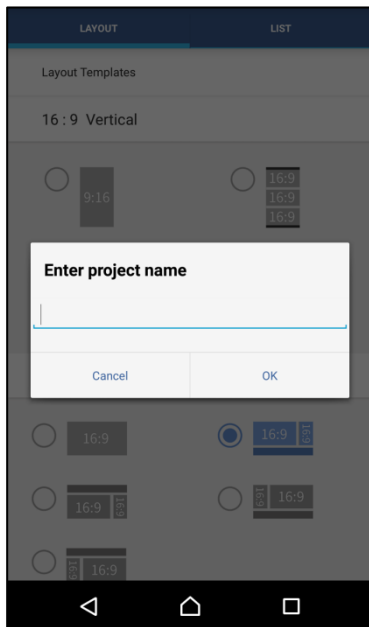



- **How does it work on a client device?**

Getting Started:

1. Select a layout template for your screen
 - ◆ Enter a project name
 - ◆ Project name can't be blank
 - ◆ Special characters (' - / ,) are not allowed
 - ◆ 20 characters maximum
2. Single tap  to add contents and long press  to edit the contents
3. After setting all contents up, tap on "Next" to schedule the project start & finish time
4. Tap on top "schedule" to check playlist
5. Tap on "OK" to finish

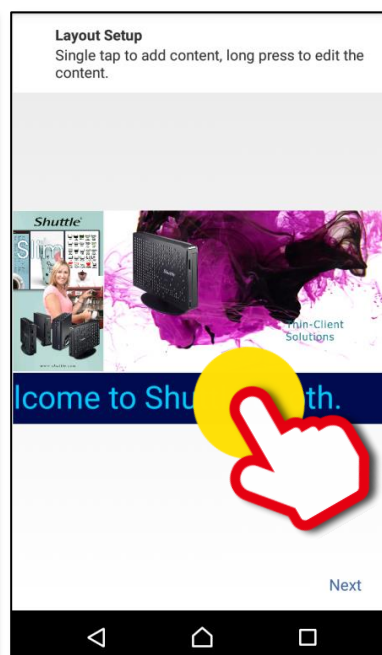
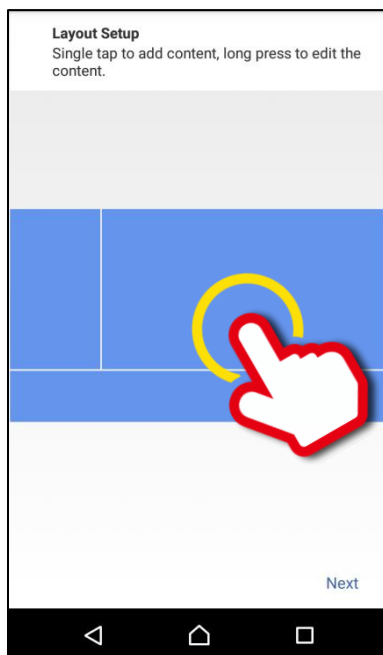

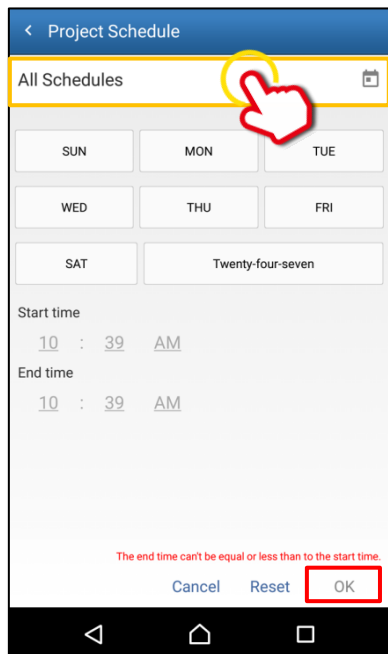
**Note:****24/7 (twenty-four seven):**

- When tap on the “24/7” button, the project will play all the time until it is manually closed.
- Playlist schedule allows only **ONE** 24/7 project.
- To edit the 24/7 project can only be overwritten with the same file name.

All schedules:

- Tap on “All schedules” button to check playlists.

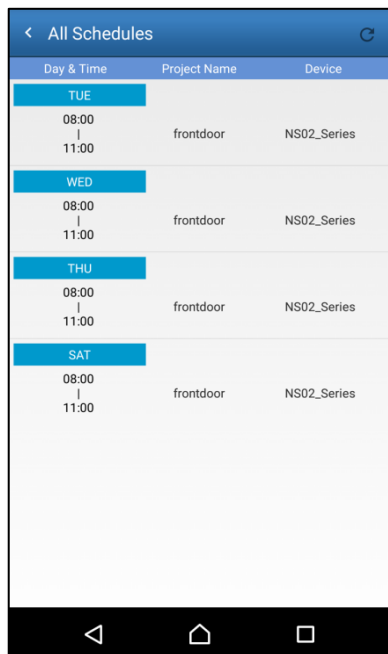

Supported format

1. The specified frames for media (pictures & videos):
 - 16:9 (1.78:1) - 4K resolution: 3840 x 2160 pixels
 - 16:9 (1.78:1) - 1080P resolution: 1920 x 1080 pixels
 - 4:3 (1.33:1) - 4K resolution: 2880 x 2160 pixels
 - 4:3 (1.33:1) - 1080P resolution: 1440 x 1080 pixels
2. Multi-media support to run:
 - **Support 4K** (3840 x 2160 pixels):
 - H.264/AVC (Landscape/ Horizontal only)
 - a. Maximum frame rate: 25fps
 - b. Maximum bit rate: 50Mbps
 - c. File format: MP4, MOV, 3GP
 - H.265/HEVC
 - a. Maximum frame rate: 60fps
 - b. Maximum bit rate: 60Mbps
 - c. File format: MP4, MOV

Note: 4K video, only single frame is supported.
 - **Support 1080P** (1920 x 1080 pixels):
 - H.264/AVC
 - a. Maximum frame rate: 60fps
 - b. Maximum bit rate: 50Mbps
 - c. File format: MP4, MOV, 3GP
 - H.265/HEVC
 - a. Maximum frame rate: 60fps
 - b. Maximum bit rate: 60Mbps
 - c. File format: MP4, MOV

Type description

Portrait/ Vertical (*all resolutions are upper limit)			
V1		Picture: 2160 x 3840px Video: 2160 x 3840px (H.265 only) Scrolling Text: Default: 48 pt	Format: .jpg, .png, .gif, .bmp Format: .mp4, .3gp, .mov Font size: 30-200 pt
V2		Picture: 1080P Video: 1080P Scrolling Text: Default: 48 pt	Format: .jpg, .png, .gif, .bmp Format: .mp4, .3gp, .mov Font size: 30-200 pt
V3/V4		Picture: 1080P Video: 1080P Scrolling Text: Default: 48 pt	Format: .jpg, .png, .gif, .bmp Format: .mp4, .3gp, .mov Font size: 30-200 pt
Landscape/ Horizontal (*all resolutions are upper limit)			
H1		Picture: 3840 x 2160px Video: 3840 x 2160px Scrolling Text: Default: 48 pt	Format: .jpg, .png, .gif, .bmp Format: .mp4, .3gp, .mov Font size: 30-200 pt
H2/H3		Picture: 1080P Video: 1080P Scrolling Text: Default: 48 pt	Format: .jpg, .png, .gif, .bmp Format: .mp4, .3gp, .mov Font size: 30-200 pt
H4/H5		Picture: 1080P Video: 1080P Scrolling Text: Default: 48 pt	Format: .jpg, .png, .gif, .bmp Format: .mp4, .3gp, .mov Font size: 30-200 pt
Landscape/ Horizontal (*all resolutions are upper limit)			
H6		Picture: 2880 x 2160px Video: 2880 x 2160px Scrolling Text: Default: 48 pt	Format: .jpg, .png, .gif, .bmp Format: .mp4, .3gp, .mov Font size: 30-200 pt
H7		Picture: 1080P Video: 1080P Scrolling Text: Default: 48 pt	Format: .jpg, .png, .gif, .bmp Format: .mp4, .3gp, .mov Font size: 30-200 pt

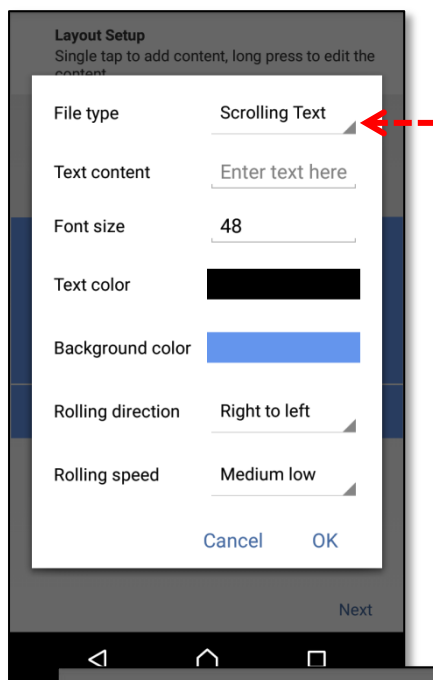

Scrolling Text

Steps:

1. Tap on "File type"
2. Choose "Scrolling Text"
3. Enter text contents (150 characters maximum)
4. Choose font size (30-200 pt)
5. Choose a text color
6. Choose a background color
7. Set text rolling direction
8. Set text rolling speed
9. Tap on "OK"
10. After setting all contents up, tap on "Next" to schedule the project start & finish time
11. Tap on "OK" to finish

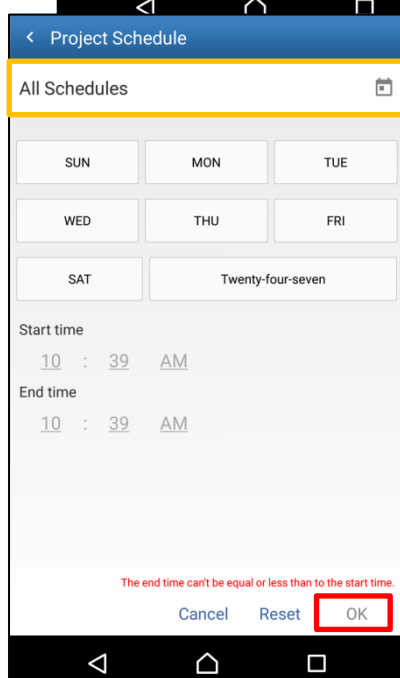
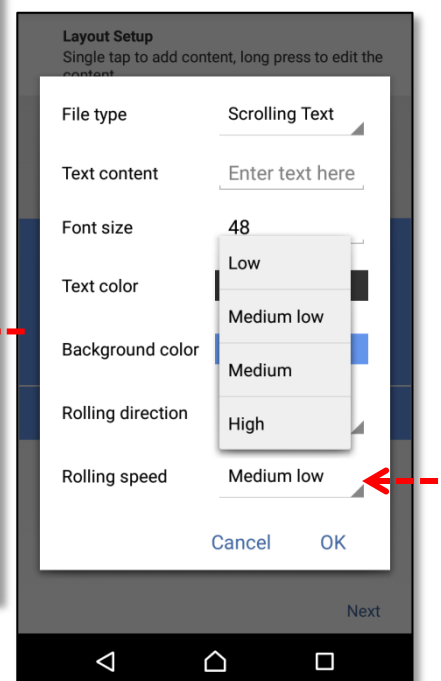
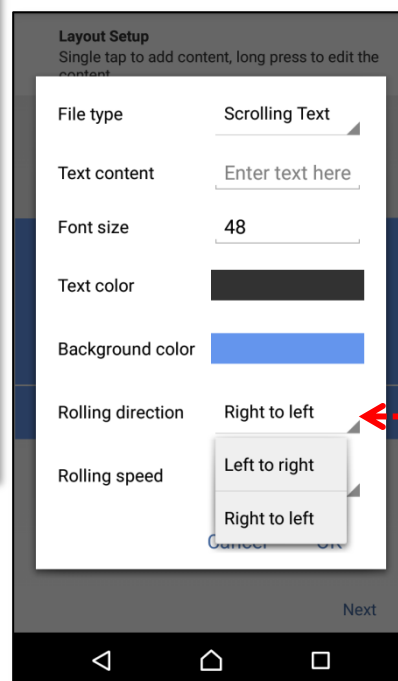
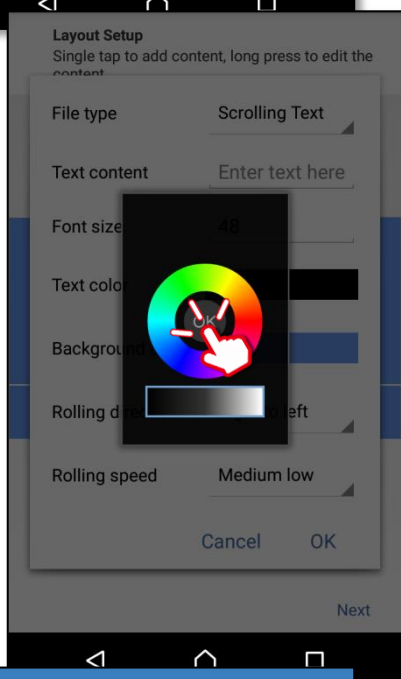

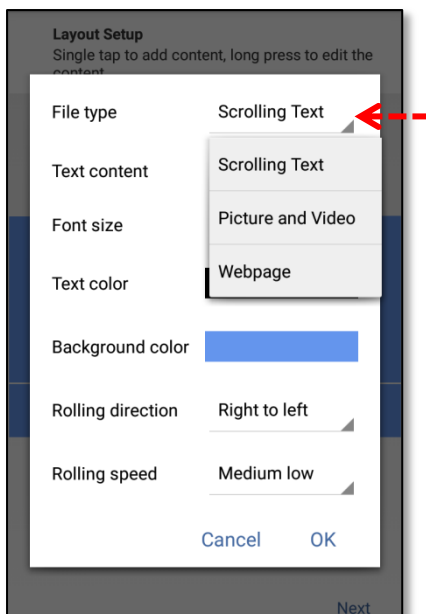

Picture and Video

Steps:

1. Tap on "File type"
2. Choose "Picture and Video"
3. Add pictures or videos (10 items maximum)
4. Set items' effects
5. Set items' switching speed
6. Tap on "OK"
7. After setting all contents up, tap on "Next" to schedule the project start & finish time
8. Tap on "OK" to finish

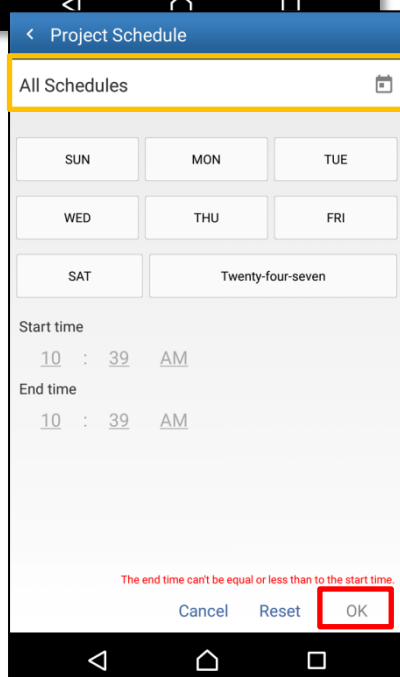
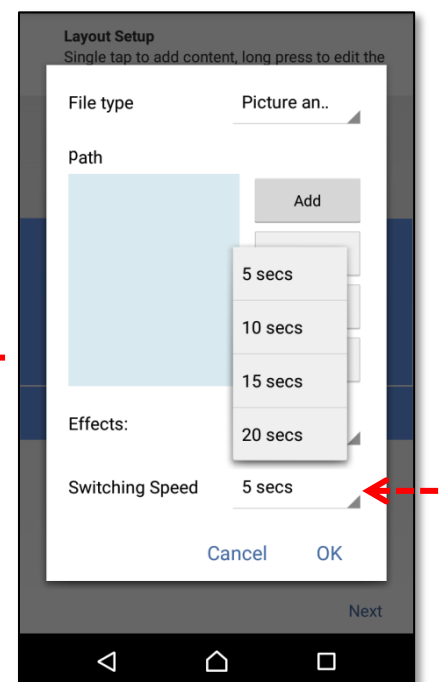
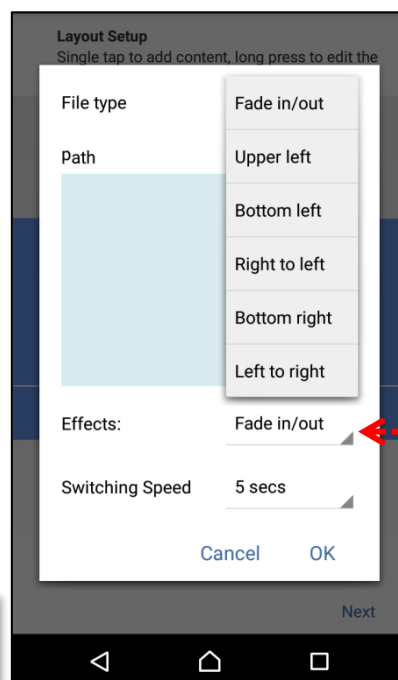
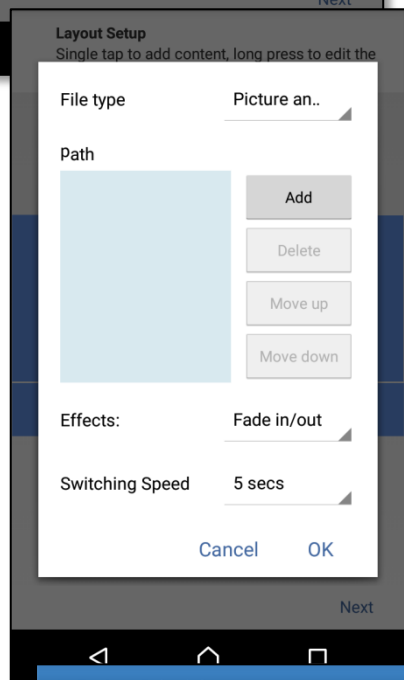

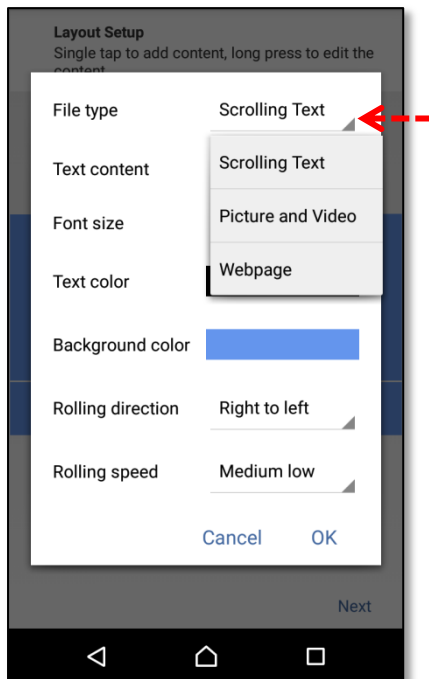

Webpage (only supports single frame layout)

Steps:

1. Tap on "File type"
2. Choose "Webpage"
3. Input "Webpage link"
4. Tap on "OK"
5. After setting all contents up, tap on "Next" to schedule the project start & finish time
6. Tap on "OK" to finish

Note:

Recommend: RWD (Responsive Web Design)

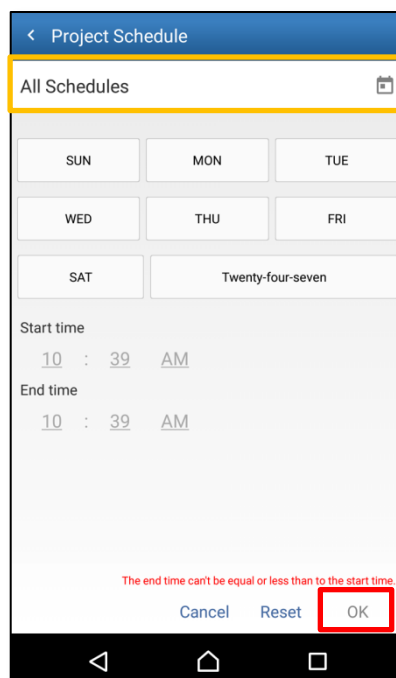
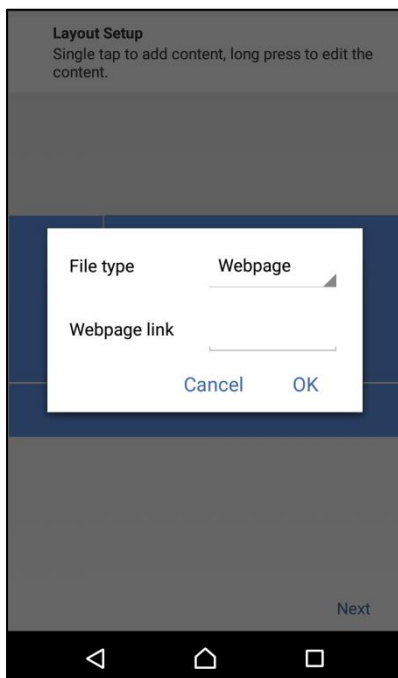

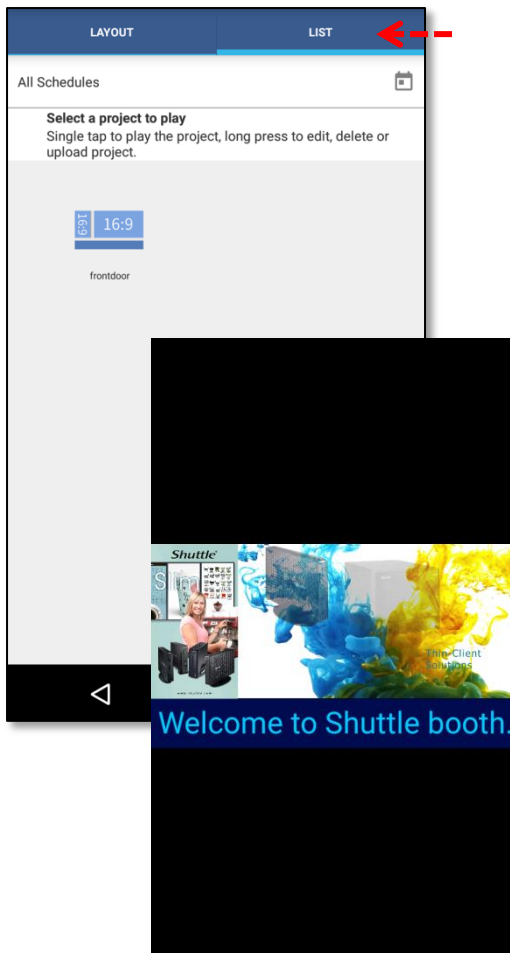

Play your project

Steps:

1. Tap on "List" menu
2. Tap  the project
The project will be played for only 30 seconds

Edit your project

Steps:

1. Tap on "List"
2. Long press  the project
3. Choose "Edit"
Original contents will be kept until modify
4. Tap on "OK"
5. After setting all contents up, tap on "Next" to schedule the project start & finish time
6. Tap on "OK" to finish

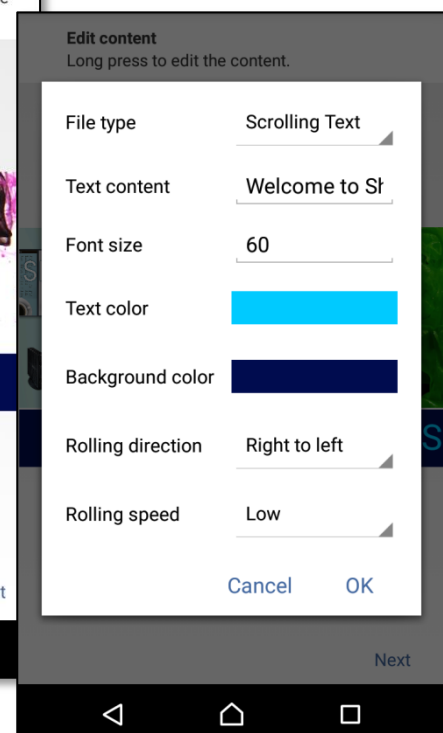
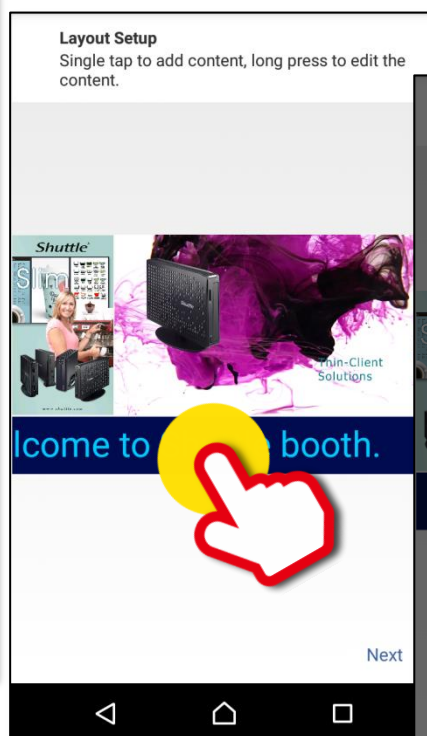
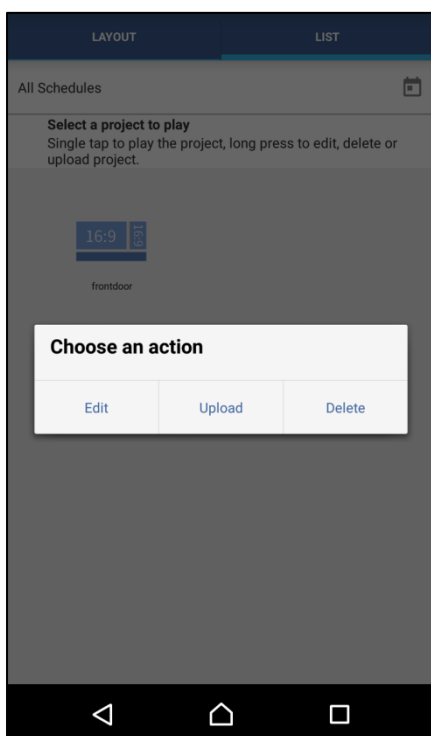

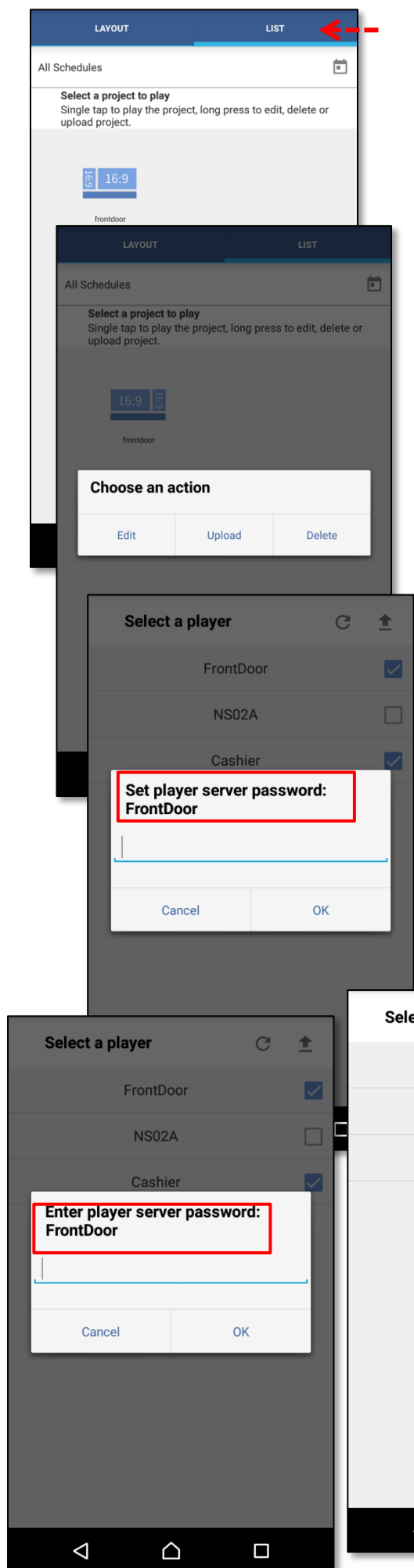

Upload a project to NS02 series

Steps:

1. Tap "List" on your device
2. Long press the project
3. Tap the "Upload" button
4. Choose the server(s)

Note: Make sure the built-in "DS Creator Pro" app on the NS02A8/E8 or NS02V2 series is running.

5. Tap the  Upload icon
6. Set player server password:
 - ◆ The first time connect to server
 - ◆ 8 characters maximum
7. Enter player server password
 - ◆ After setting the server password for the first time
8. Tap on "OK" to upload the project

Note:

Tap server to modify the name

- ◆ 20 characters maximum
- ◆ Special characters (' - / ,) are not allowed

Overview on the NS02 series

Start the “DS Creator Pro” app on your NS02 series. There are 11 types of layout templates for your needs.

Note: To upload project content from a client device, please make sure the built-in "DS Creator Duo" app is running.

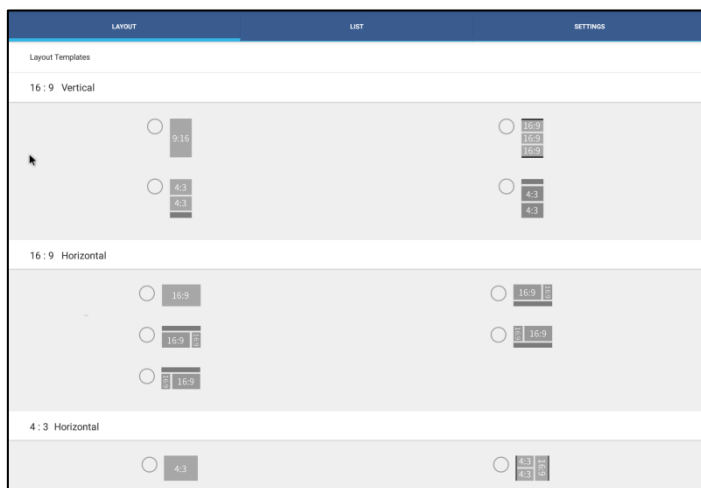

Scrolling Text

- Default size: 48 pt
- Font size: 30-200 pt

Picture

- Format: JPG, PNG, GIF, BMP

Video

- Format: MPEG-4 (H.264/8-bit), 3GPP (Android device only)

Webpage (only supports single frame layout)

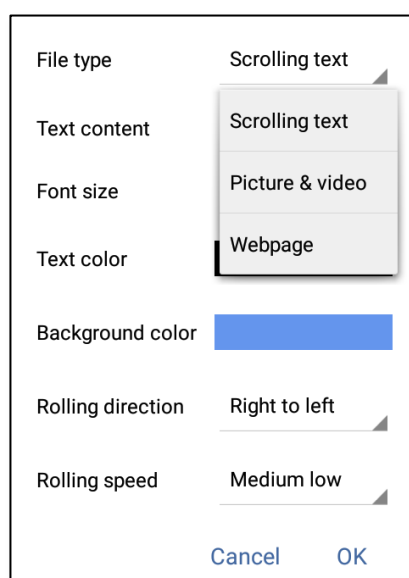
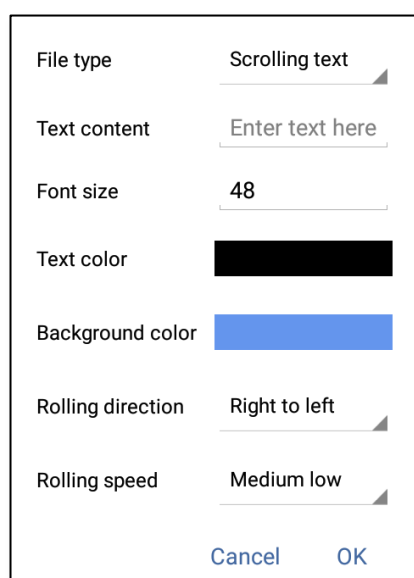
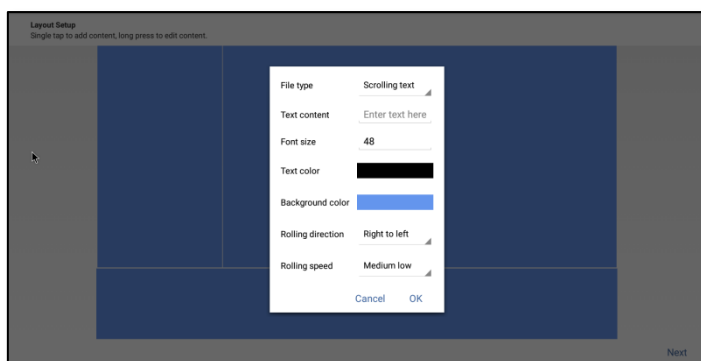

- Recommend: RWD(Responsive Web Design)

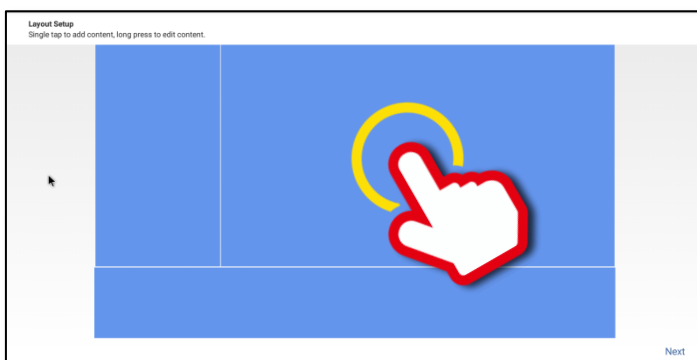
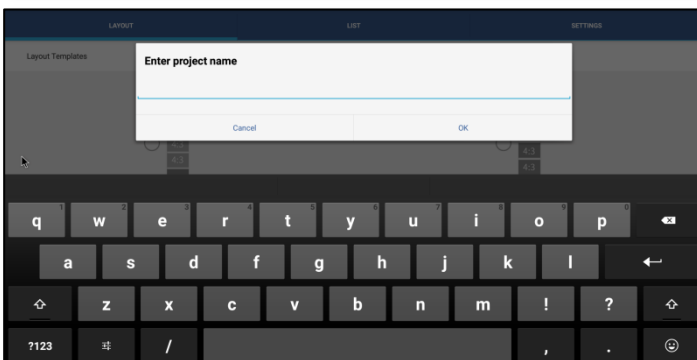
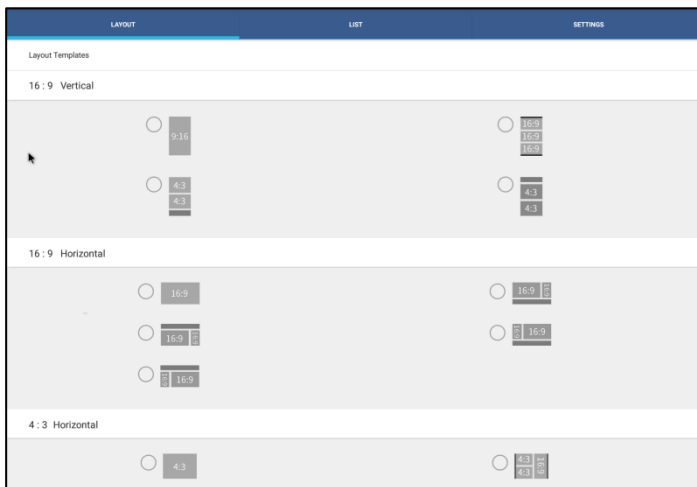

How does it work on a NS02 series?



Getting Started:

1. Select a layout template for your screen
 - ◆ Enter project name
 - ◆ Project name can't be blank
 - ◆ Special characters (' - / ,) are not allowed
 - ◆ 20 characters maximum
2. Single click  to add contents and long press  to edit the contents

Note:

Click on “Next” button after you create or edit digital signage contents.

Project Schedule

All Schedules

SUN MON TUE

WED THU FRI

SAT Twenty-four seven

Start time 8 : 0 AM

End time 11 : 0 AM

The end time can't be equal or less than the start time

Cancel Reset OK

3. After setting all contents up, click on “Next” to schedule the project start & finish time
4. Click on “OK” to finish

Project Schedule

All Schedules

SUN MON TUE

WED THU FRI

SAT Twenty-four seven

Cancel Reset OK

Note:

24/7 (twenty-four seven):

- When click on the “24/7” button, the project will play all the time until it is manually closed.
- Playlist schedule allows only **ONE** 24/7 project.
- To edit the 24/7 project can only be overwritten with the same file name.

Project Schedule

All Schedules

SUN MON TUE

WED THU FRI

SAT Twenty-four seven

Cancel Reset OK

All schedules:

- Click on “All schedules” button to check playlists.



Day & Time	Project Name	Device
SUN		
00:00 - 24:00		
08:00 - 11:00	Frontdoor	
MON		
00:00 - 24:00		
08:00 - 09:00	Cashier	
10:01 - 12:00	2F Digital Signage	
TUE		
00:00 - 24:00		
10:01 - 12:00	2F Digital Signage	



Supported format

1. The specified frames for media (pictures & videos):
 - 16:9 (1.78:1) - 4K resolution: 3840 x 2160 pixels
 - 16:9 (1.78:1) - 1080P resolution: 1920 x 1080 pixels
 - 4:3 (1.33:1) - 4K resolution: 2880 x 2160 pixels
 - 4:3 (1.33:1) - 1080P resolution: 1440 x 1080 pixels
2. Multi-media support to run:
 - **Support 4K** (3840 x 2160 pixels):
 - H.264/AVC (Landscape/ Horizontal only)
 - a. Maximum frame rate: 25fps
 - b. Maximum bit rate: 50Mbps
 - c. File format: MP4, MOV, 3GP
 - H.265/HEVC
 - a. Maximum frame rate: 60fps
 - b. Maximum bit rate: 60Mbps
 - c. File format: MP4, MOV

Note: 4K video, only single frame is supported.
 - **Support 1080P** (1920 x 1080 pixels):
 - H.264/AVC
 - a. Maximum frame rate: 60fps
 - b. Maximum bit rate: 50Mbps
 - c. File format: MP4, MOV, 3GP
 - H.265/HEVC
 - a. Maximum frame rate: 60fps
 - b. Maximum bit rate: 60Mbps
 - c. File format: MP4, MOV

Type description

Portrait/ Vertical (*all resolutions are upper limit)			
V1		Picture: 2160 x 3840px Video: 2160 x 3840px (H.265 only) Scrolling Text: Default: 48 pt	Format: .jpg, .png, .gif, .bmp Format: .mp4, .3gp, .mov Font size: 30-200 pt
V2		Picture: 1080P Video: 1080P Scrolling Text: Default: 48 pt	Format: .jpg, .png, .gif, .bmp Format: .mp4, .3gp, .mov Font size: 30-200 pt
V3/V4		Picture: 1080P Video: 1080P Scrolling Text: Default: 48 pt	Format: .jpg, .png, .gif, .bmp Format: .mp4, .3gp, .mov Font size: 30-200 pt
Landscape/ Horizontal (*all resolutions are upper limit)			
H1		Picture: 3840 x 2160px Video: 3840 x 2160px Scrolling Text: Default: 48 pt	Format: .jpg, .png, .gif, .bmp Format: .mp4, .3gp, .mov Font size: 30-200 pt
H2/H3		Picture: 1080P Video: 1080P Scrolling Text: Default: 48 pt	Format: .jpg, .png, .gif, .bmp Format: .mp4, .3gp, .mov Font size: 30-200 pt
H4/H5		Picture: 1080P Video: 1080P Scrolling Text: Default: 48 pt	Format: .jpg, .png, .gif, .bmp Format: .mp4, .3gp, .mov Font size: 30-200 pt
Landscape/ Horizontal (*all resolutions are upper limit)			
H6		Picture: 2880 x 2160px Video: 2880 x 2160px Scrolling Text: Default: 48 pt	Format: .jpg, .png, .gif, .bmp Format: .mp4, .3gp, .mov Font size: 30-200 pt
H7		Picture: 1080P Video: 1080P Scrolling Text: Default: 48 pt	Format: .jpg, .png, .gif, .bmp Format: .mp4, .3gp, .mov Font size: 30-200 pt

File type	Scrolling text
Text content	Enter text here
Font size	48
Text color	
Background color	
Rolling direction	Right to left
Rolling speed	Medium low
<div>Cancel</div> <div>OK</div>	

Scrolling Text

Steps:

1. Click on "File type"
2. Choose "Scrolling Text"
3. Enter text contents (150 characters maximum)
4. Choose font size (30-200 pt)
5. Choose a text color
6. Choose a background color
7. Set text rolling direction
8. Set text rolling speed
9. After setting all contents up, click on "Next" to schedule the project start & finish time
10. Click on "OK" to finish

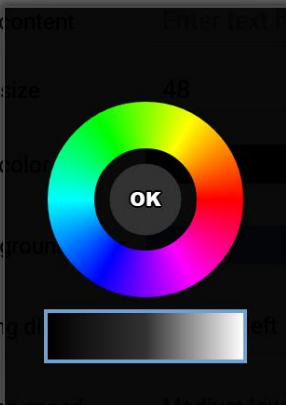

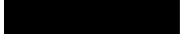
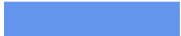
File type	Scrolling text
Text content	Enter text here
Font size	48
Text color	
Background color	
Rolling direction	Right to left
Rolling speed	<div>Left to right</div> <div>Right to left</div>
<div>Cancel</div> <div>OK</div>	

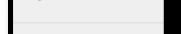
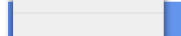
File type	Scrolling text
Text content	Enter text here
Font size	48
Text color	
Background color	
Rolling direction	Right to left
Rolling speed	<div>Low</div> <div>Medium low</div> <div>Medium</div> <div>High</div>
<div>Cancel</div> <div>OK</div>	

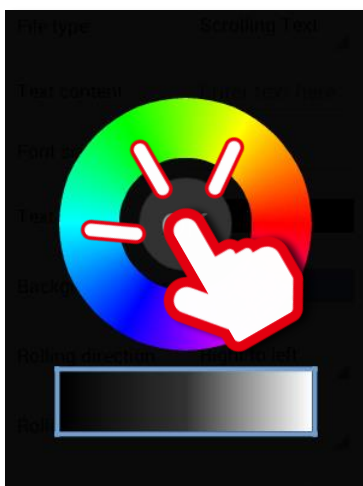

Note:

After choosing a color, click the circle button.

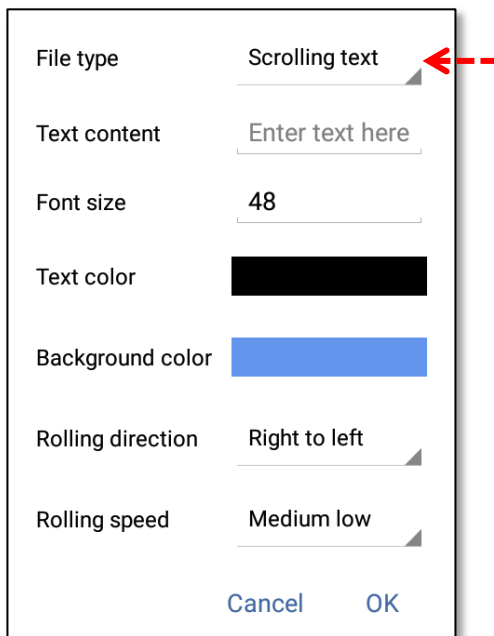

File type: Scrolling text

Text content: Enter text here

Font size: 48

Text color: [Black color swatch]

Background color: [Blue color swatch]

Rolling direction: Right to left

Rolling speed: Medium low

Cancel OK

Picture and Video

Steps:

1. Click on "File type"
2. Choose "Picture and Video"
3. Add pictures or videos (10 items maximum)
4. Set items' effects
5. Set items' switching speed
6. After setting all contents up, click on "Next" to schedule the project start & finish time
7. Click on "OK" to finish

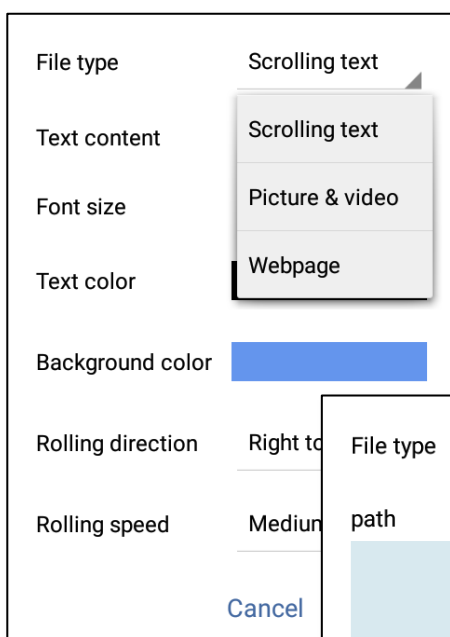

File type: Scrolling text

Text content: Scrolling text

Font size: Picture & video

Text color: Webpage

Background color: [Blue color swatch]

Rolling direction: Right to left

Rolling speed: Medium low

Cancel

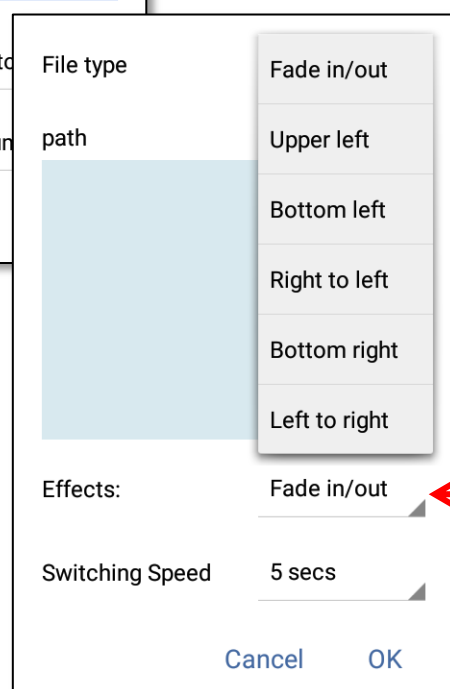

File type: Picture & video

path: [Image placeholder]

Effects: Fade in/out

Switching Speed: 5 secs

Cancel OK

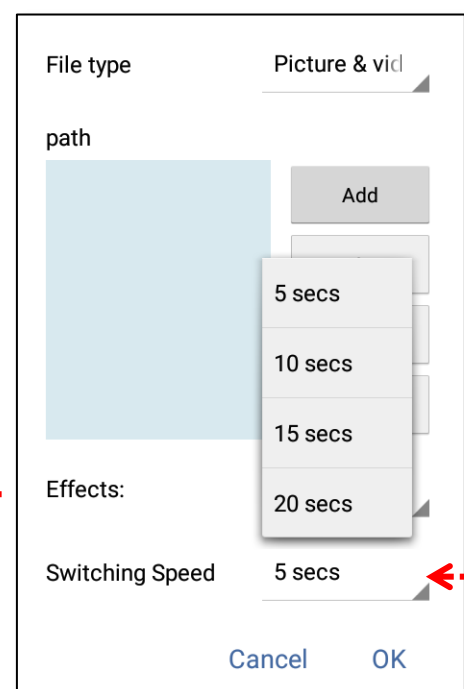

File type: Picture & video

path: [Image placeholder]

Add

5 secs

10 secs

15 secs

20 secs

Effects: [Dropdown menu]

Switching Speed: 5 secs

Cancel OK

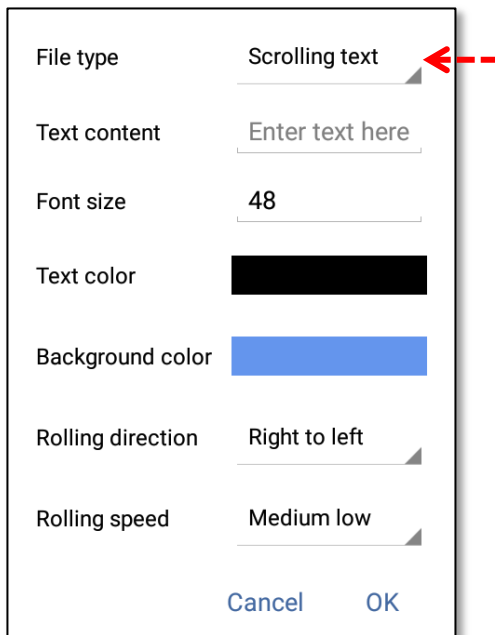

File type Scrolling text

Text content Enter text here

Font size 48

Text color

Background color

Rolling direction Right to left

Rolling speed Medium low

Cancel OK

Webpage (only supports single frame layout)

Steps:

1. Click on "File type"
2. Choose "Webpage"
3. Enter a web link
4. After setting all contents up, click on "Next" to schedule the project start & finish time
5. Click on "OK" to finish

Note:

Recommend: RWD (Responsive Web Design)

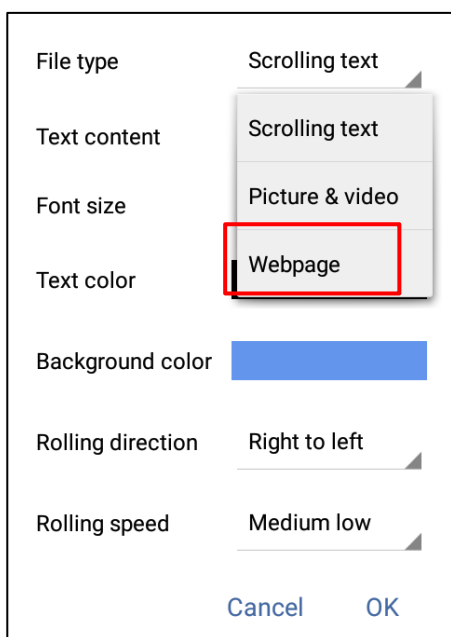

File type Scrolling text

Text content Scrolling text

Font size Picture & video

Text color Webpage

Background color

Rolling direction Right to left

Rolling speed Medium low

Cancel OK

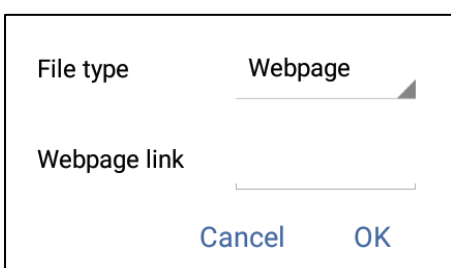

File type Webpage

Webpage link

Cancel OK

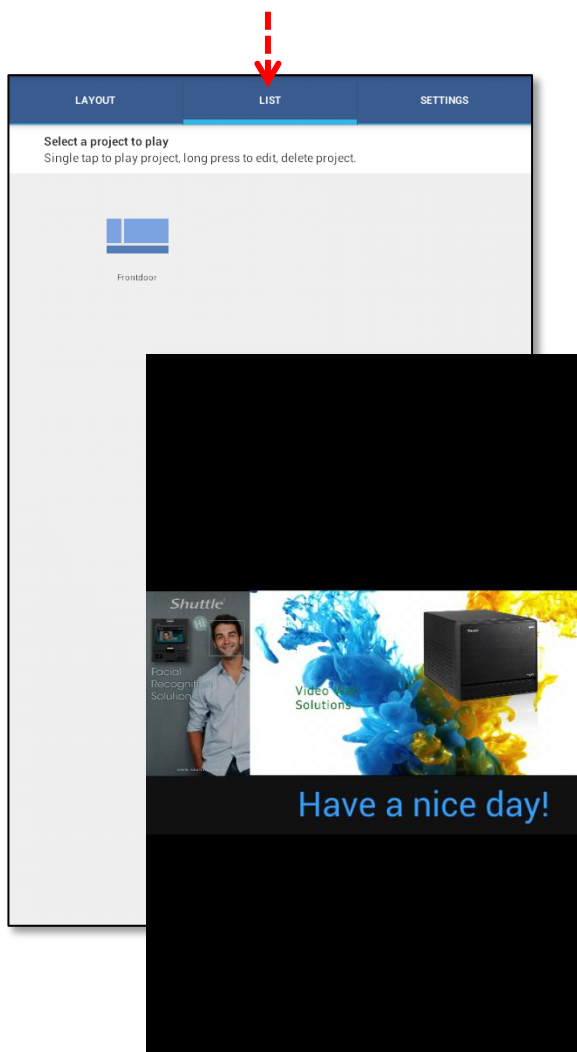

Play your project

Steps:

1. Click on "List" menu
2. Tap  the project
The project will be played until the server enters standby mode

Edit your project

Steps:

1. Click on "List" menu
2. Long press  the project
Original contents will be kept until modify
3. Choose "Edit"
4. Click on "OK"
5. Click on "Next" to schedule the project start & finish time
6. Click on "OK" to finish

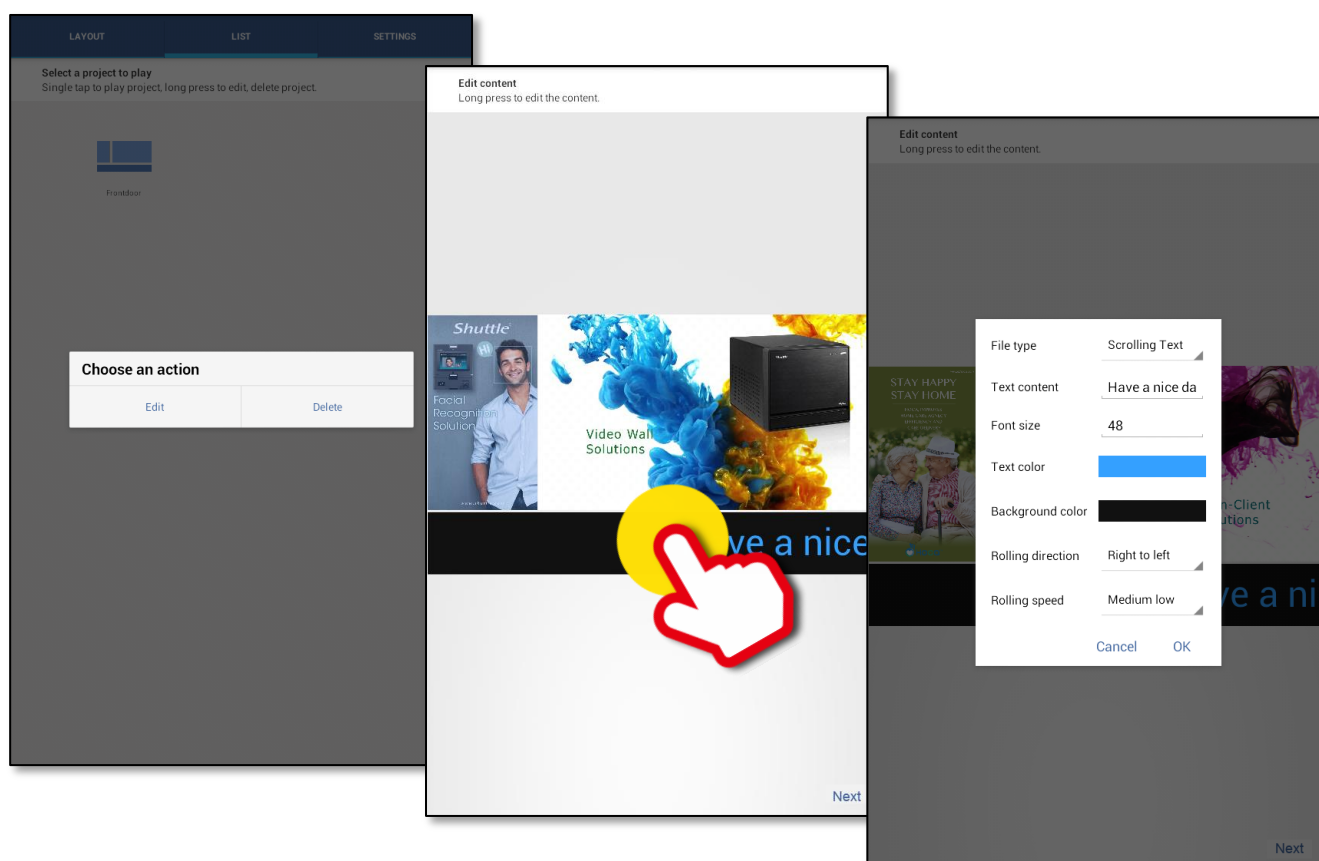

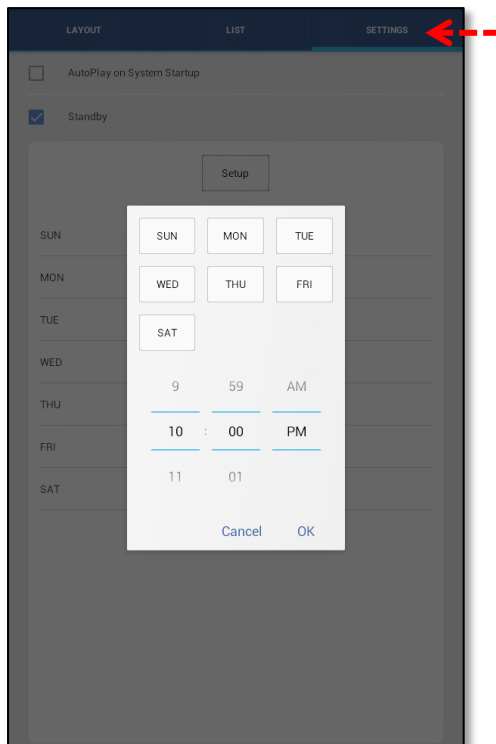

Set schedule on a NS02 series

The last project that you upload from your client device will be played until you upload another project or the NS02A8/E8 or NS02V2 series enters standby mode.

Steps:

1. Click on “Settings” menu
2. Check “Standby”
3. Set Weekdays and time
4. Click on “OK” to finish

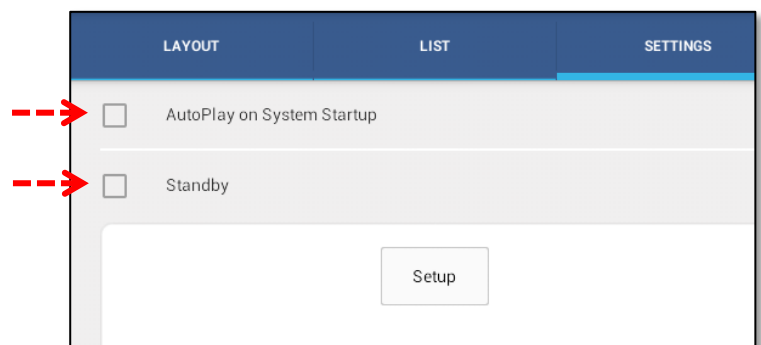

Note:

“AutoPlay on System Startup”:

NS02 series will auto play the latest project after system startup.

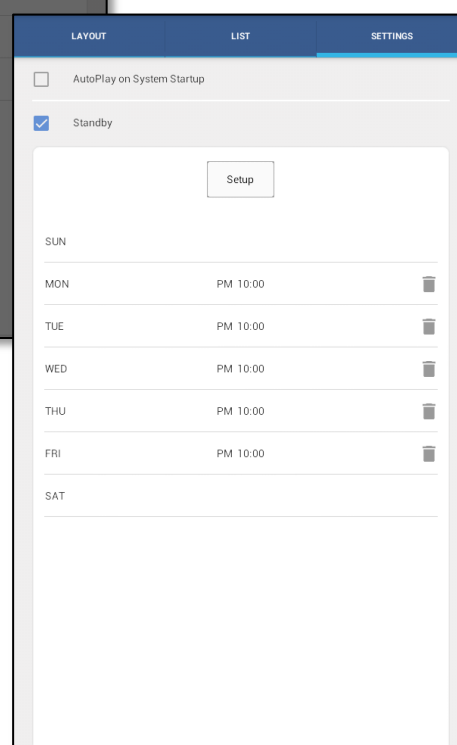
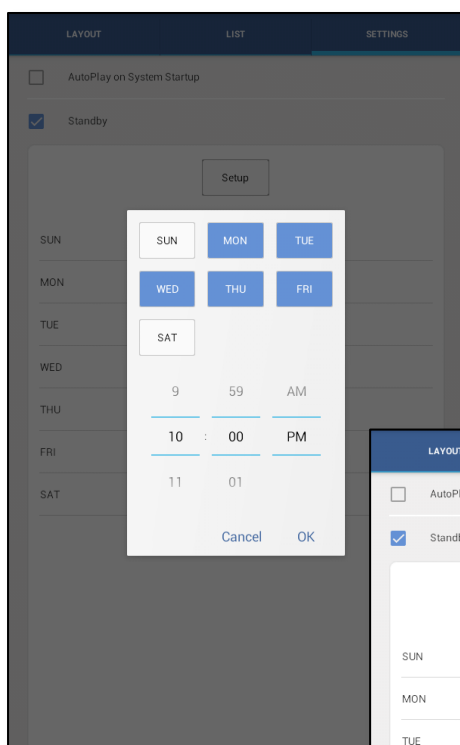



Shuttle Inc.

<http://global.shuttle.com>

Department E-mail Contacts:

Sales: sales@tw.shuttle.com

Technical Support E-mail: support@tw.shuttle.com

Media Contact: shuttlepr@tw.shuttle.com