

K45 Barebones Quick Guide 【English】

Front panel

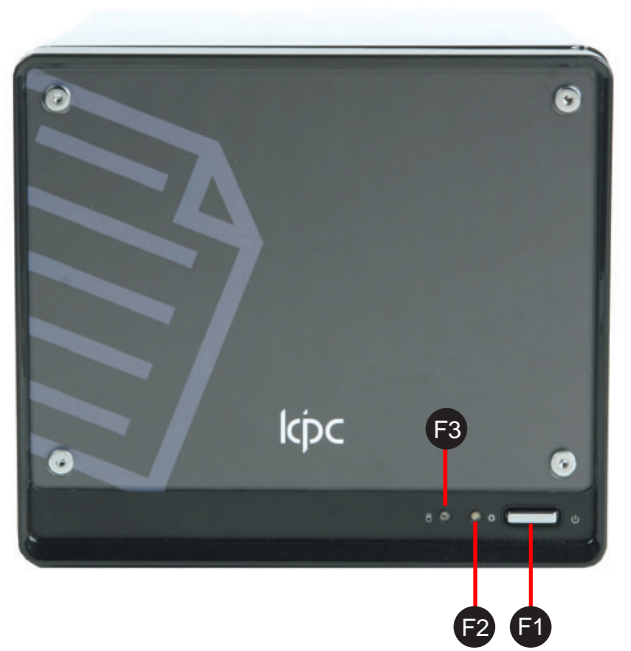

- F1. Power Switch
- F2. Power LED
- F3. HDD LED

Back panel

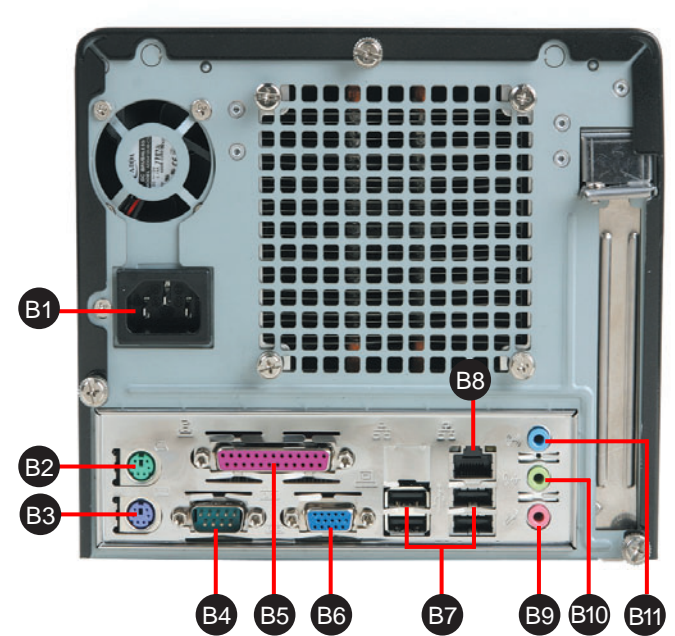

- B1. AC Power Socket
- B2. PS/2 Mouse Port
- B3. PS/2 Keyboard Port
- B4. COM Port
- B5. Parallel Port
- B6. VGA Port
- B7. USB Port
- B8. LAN Port
- B9. MIC-In Port
- B10. Front-Out (L/R) Port
- B11. Line-In Port

Mainboard illustration

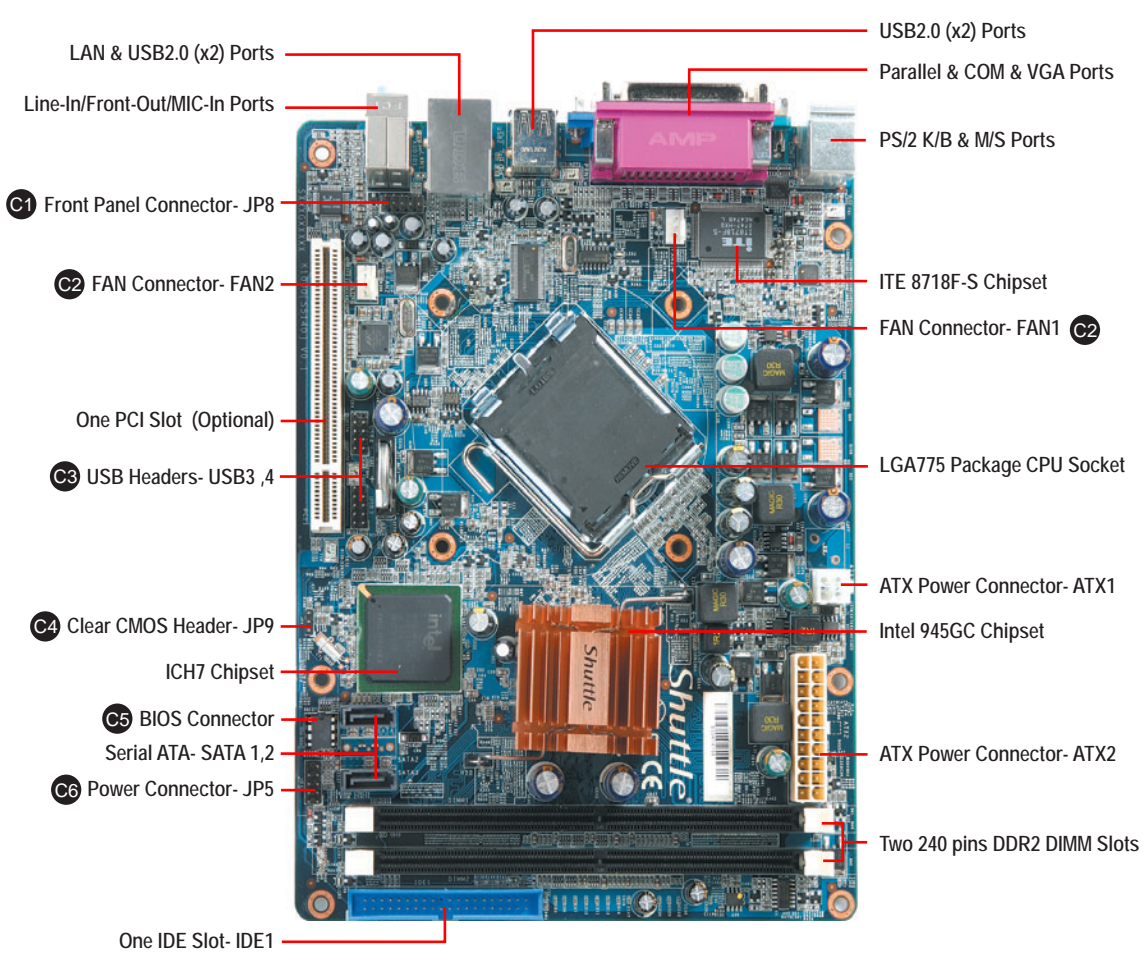

Jumper Settings

C1 Front Panel Connector

- Pin Assignments (JP8):
- 1=MIC2\_L
  - 2=AGND
  - 3=MIC2\_R
  - 4=FRONT CTL
  - 5=LINE2-R
  - 6=SENSE1\_RETURN
  - 7=FRONT\_SENSE
  - 8=NC
  - 9=LINE2-L
  - 10=SENSE2\_RETURN

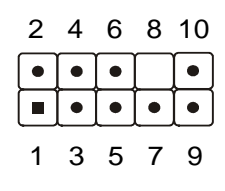

C2 Fan Connectors

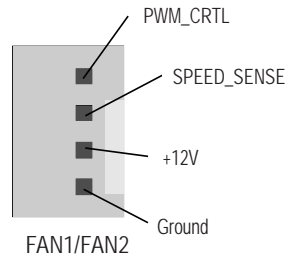

C3 USB Connectors

- Pin Assignments (USB3):
- 1=USBPW3
  - 2=USBPW3
  - 3=USBP2N
  - 4=USBP3N
  - 5=USBP2P
  - 6=USBP3P
  - 7=GND
  - 8=GND
  - 9=KEY
  - 10=GND

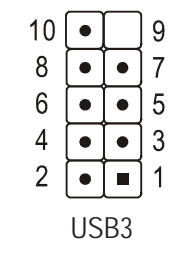

- Pin Assignments (USB4):
- 1=USBPW4
  - 2=USBPW4
  - 3=USBP6N
  - 4=USBP7N
  - 5=USBP6P
  - 6=USBP7P
  - 7=GND
  - 8=GND
  - 9=KEY
  - 10=GND

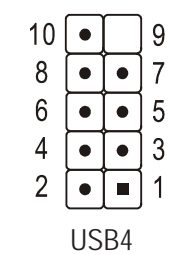

C4 Clear CMOS Header

- Pin Assignments (JP9):
- 1=RTC\_RST-
  - 2=-RTCST
  - 3=-RTCBTN

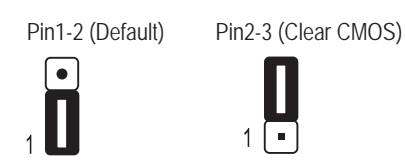

C5 BIOS Connector

- Pin Assignments:
- 1=SPI\_CS0-
  - 2=SPI\_MISO
  - 3=SPI\_WP-
  - 4=GND
  - 5=SPI\_MOSI
  - 6=SPI\_CLK
  - 7=SPI\_HOLD-
  - 8=SPI\_VDD

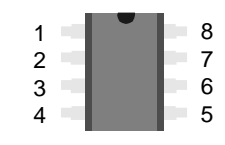

C6 Power Connector

- Pin Assignments (JP5):
- 1=HDLED\_PU
  - 2=GRNLEDA
  - 3=-HD\_LED
  - 4=GRNLEDB
  - 5=BT\_SEL
  - 6=-PWRSW
  - 7=GND
  - 8=GND
  - 9=NC
  - 10=KEY

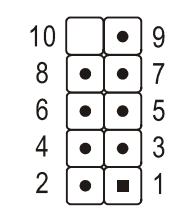

A. Begin Installation

Note: For safety reasons, please ensure that the power cord is disconnected before opening the case.

1. Unscrew 3 thumbscrews of the chassis cover.

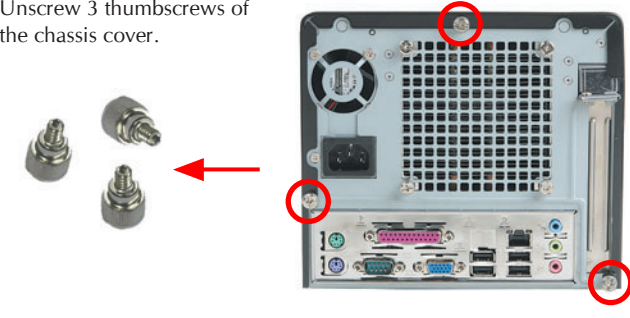

2. Slide the cover backwards and upwards.

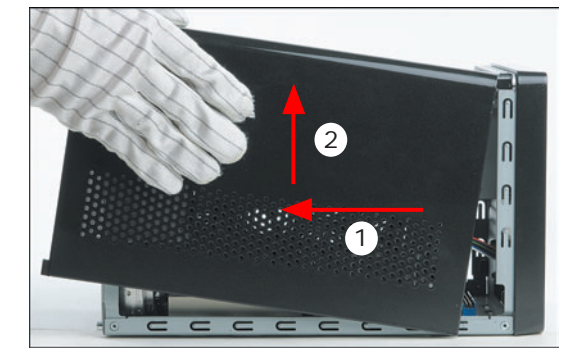

B. CPU Installation

Note: If your xpc has Shuttle ICE module (Optional), proceed to step1 ~ 3. Remove the Shuttle ICE module first.

1. Unfasten the Shuttle ICE fan thumbscrews on the back of the chassis.

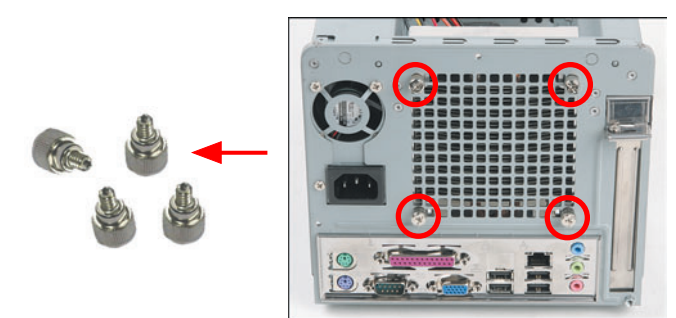

2. Unfasten the four Shuttle ICE module attachment screws and unplug the fan connector.

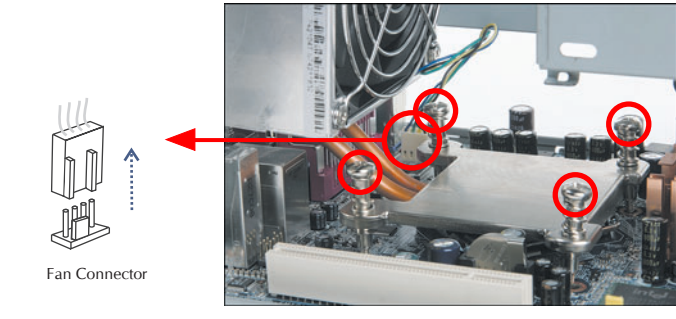

3. Remove the Shuttle ICE module from the chassis and put it aside.

4. First unlock and raise the socket lever, lift the metal load plate on the CPU socket.

Note: This 775 pin socket is fragile and easily damaged. Always use extreme care when installing a CPU and limit the number of times that you remove or change the CPU.

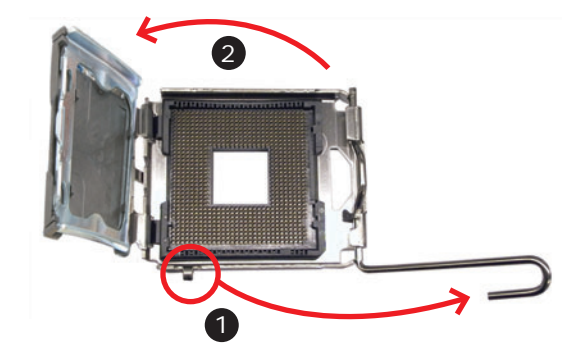

5. Orientate the CPU and socket, aligning the yellow triangle on the corner of the CPU with the triangle on the socket. Making sure the CPU is perfectly horizontal, insert the CPU into the socket. Close the load plate, lower the CPU socket lever and lock in place.

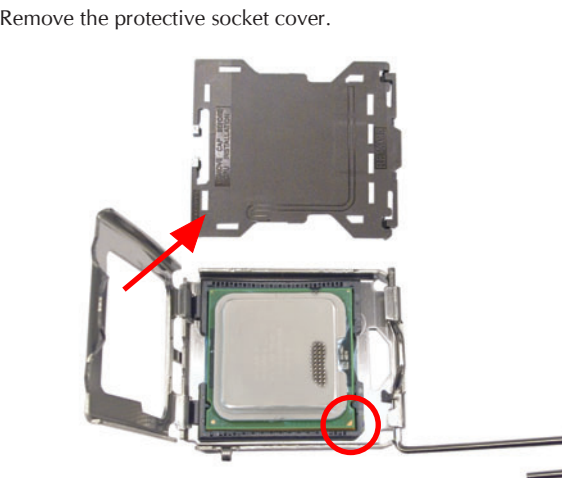

6. Remove the protective socket cover.

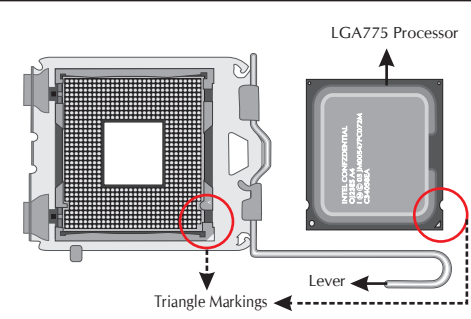

Note: Failure to correctly align the CPU and socket can result in damage to the CPU.

7. Spread an even layer of thermal compound on the CPU die.



Note: Please do not use too much Heatsink compound.

C. FAN Installation

Note: If you are installing the Intel CPU FAN, proceed to step1. If you are installing the Shuttle ICE module (Optional), proceed to step2 ~ 4.

1. Screw the Intel CPU FAN to the mainboard and connect the fan connector.

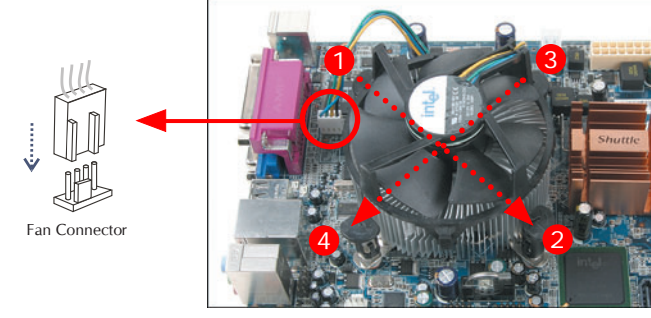

Note: Please refer to the user guide of the Intel CPU FAN you bought to install the fan.

2. Screw the Shuttle ICE module to the mainboard. Note to press down on the opposite diagonal corner while tightening each screw.

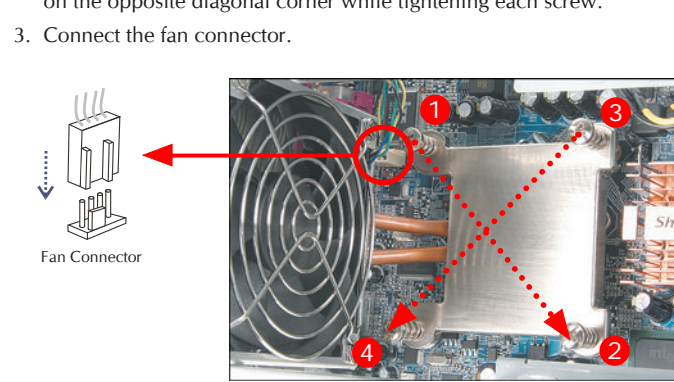

3. Connect the fan connector.

4. Fasten the Shuttle ICE fan to the chassis with the 4 thumbscrews.

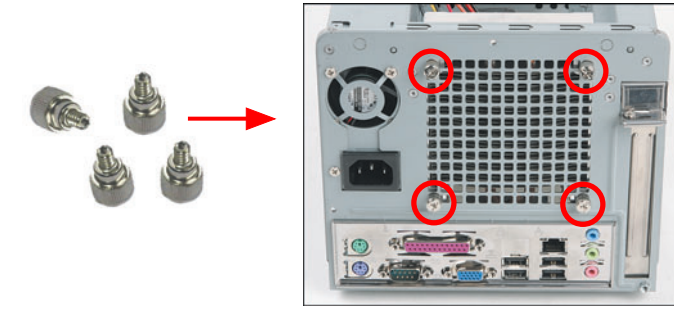

D. DDR2 Installation

1. Unlock the DIMM latch.
2. Align the DDR2 module's cutout with the DIMM slot notch. Slide the DDR2 module into the DIMM slot.

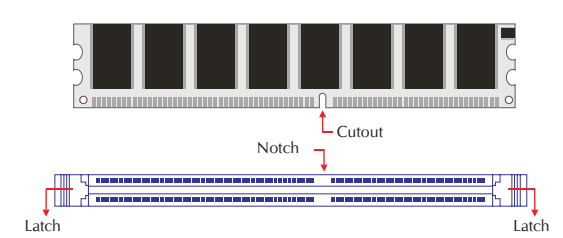

3. Check that the latches are closed, and the DDR2 modules are firmly installed.

Note: Repeat to install additional DDR2 modules if desired.

E. HDD Installation

1. Slide the hard disk drive (HDD) into the chassis.



2. Fasten the four side screws.

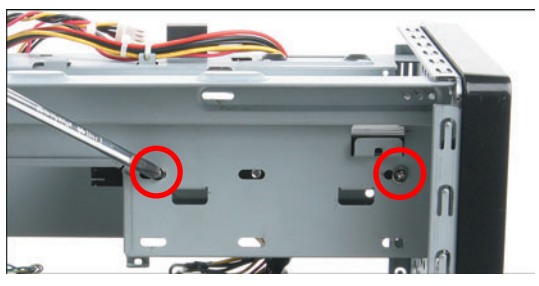

Note: Please make sure to secure the screws on each side.

3. Plug the Serial ATA cable to the SATA1/SATA2 header.

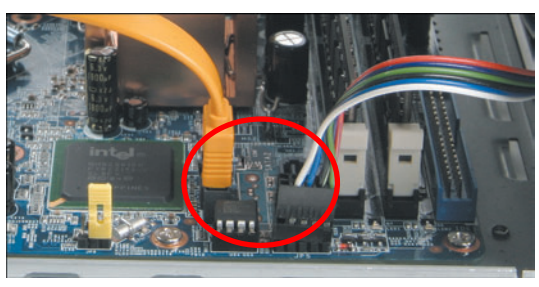

4. Connect the Serial ATA and power cables to the HDD.

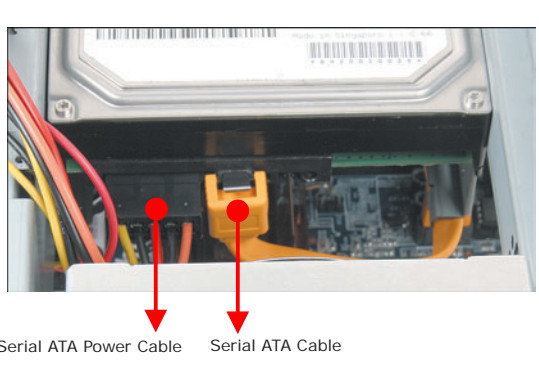

F. Accessories Installation

1. Unfasten expansion slot bracket screws. Remove the back panel bracket and put the bracket aside.

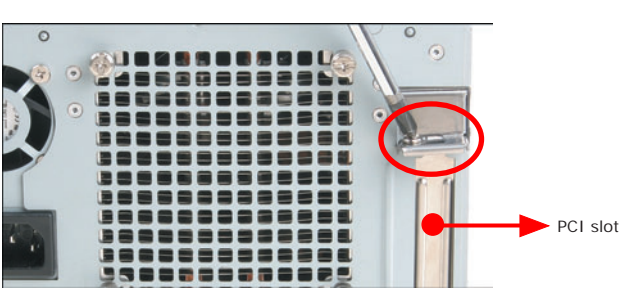

2. Install the PCI card into the PCI slot (Optional).

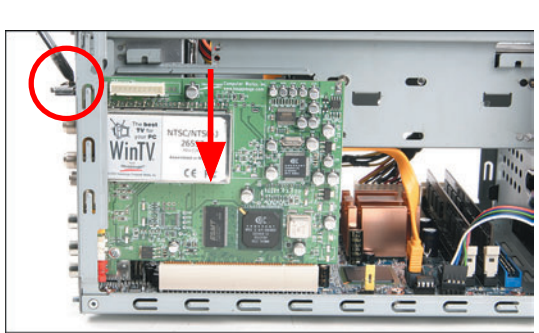

3. Secure the bracket.

G. Complete

1. Replace the cover and refasten the thumbscrews.

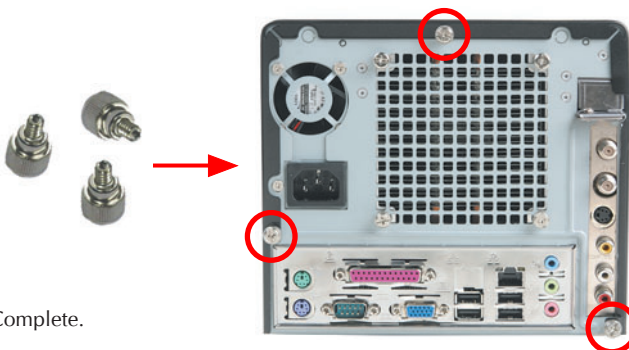

2. Complete.

Note: Please load the optimized BIOS values.



## Front panel

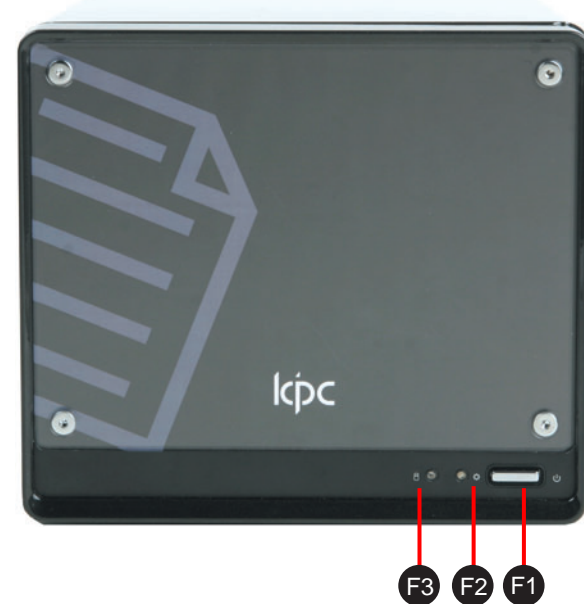

- F1. Power Switch
- F2. Power LED
- F3. HDD LED

## Back panel

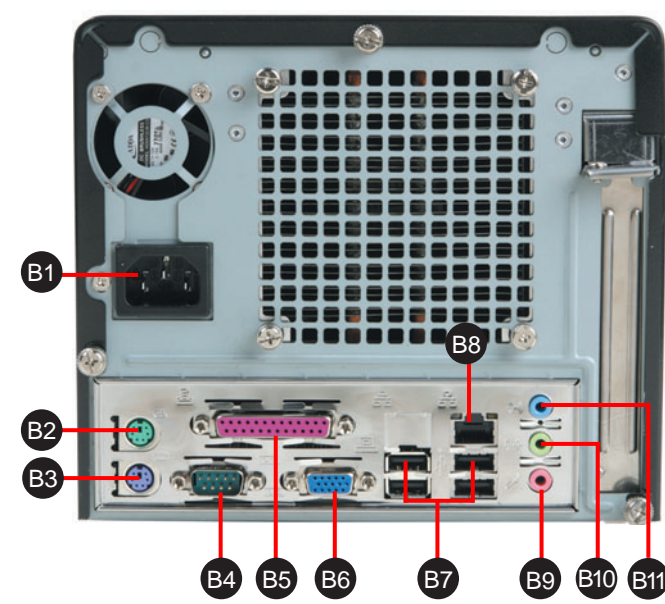

- B1. AC Power Socket
- B2. PS/2 Mouse Port
- B3. PS/2 Keyboard Port
- B4. COM Port
- B5. Parallel Port
- B6. VGA Port
- B7. USB Ports
- B8. LAN Port
- B9. MIC-In Port
- B10. Front-Out (L/R) Port
- B11. Line-In Port

### 1 Connecting Keyboard and Mouse (PS/2 Mouse, PS/2 Keyboard Port)



### 2 Connecting Monitor (VGA Port)



### 3 Connecting USB device (USB Ports)

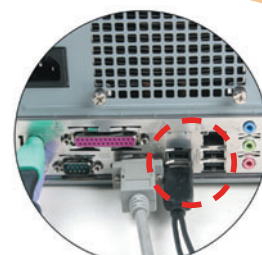

### 4 Connecting the Network (LAN Port)

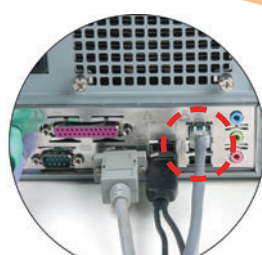
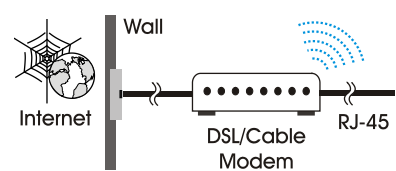

### 5 Connecting Speaker (Front-Out Port)



Support 5.1 channels

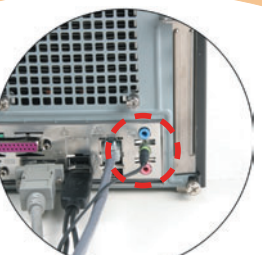

### 8 Powering on the system (Power Switch)

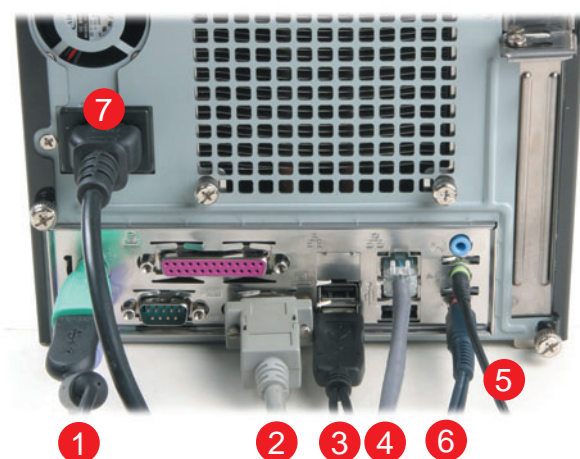

### 7 Connecting Power (AC Power Socket)



### 6 Connecting Headphone & Microphone (Front-Out & MIC-In Port)

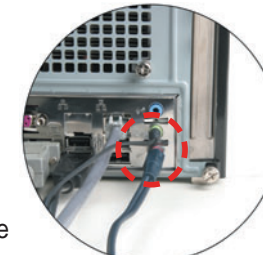

## Customize Your Front Panel 【 English 】

1



Unfasten the front panel by removing the four screws.

4



Align and correspond the transparent glass and new image to screw holes on the front of the machine.

2



Remove both the transparent glass and the image.

5



Carefully screw back the four screws.

3



Insert the new image and cover back the transparent glass on top.

6



Congraduation, you have your customized image now.